

2023

Hanover 387





First impressions Count, but you don't have to worry about that.

The Hanover 387 has a sumptuous feel and a Hard-Top that stands out, delivering comfort, the greatest design, and durability, making your voyage truly unforgettable.

MAKE MEMORIES LAST.

Hanover



Hanover 387

2023



Hanover 387

2023



Hanover 387

2023

TECHNICAL SPECIFICATIONS



LENGTH
37'5" / 11.40 m



BEAM
10' 7" / 3.22 m



DRAFT
33" / 0.8m



DRY WEIGHT
10,580 lbs / 4800 kg



FUEL TANK CAPACITY
150 gal / 567 L



WATER TANK CAPACITY
50 gal / 190 L



HOLDING TANK
20 gal / 75 L



CAPACITY
15 day / 5 Night



CRUISING SPEED
22-24 mph / 31.3 kph



WIDE OPEN THROTTLE
43-45 mph / 69.2-72.4 kph



DEADRISE
16°



BRIDGE CLEARANCE
10'7" / 3.2 m
12'7" / 3.8 m with radar
or anchor light



Hanover 387

2023

A CABIN

- 1 Kitchen with sink, synthetic granite top, space for microwave, induction stove, fridge, 3 drawers and two cabinets
- 2 Stainless steel staircase with 3 wide teak steps
- 3 Acrylic access sliding door with lock and key
- 4 Vinilic special flooring
- 5 Decorative mirror on the bow
- 6 U-shaped sofa for 3 people convertibles into a double bed, with teak retractable table
- 7 Couple bed in the middle ship cabin
- 8 Sofa in the middle ship cabin
- 9 Free standing up of 9' in cabin center

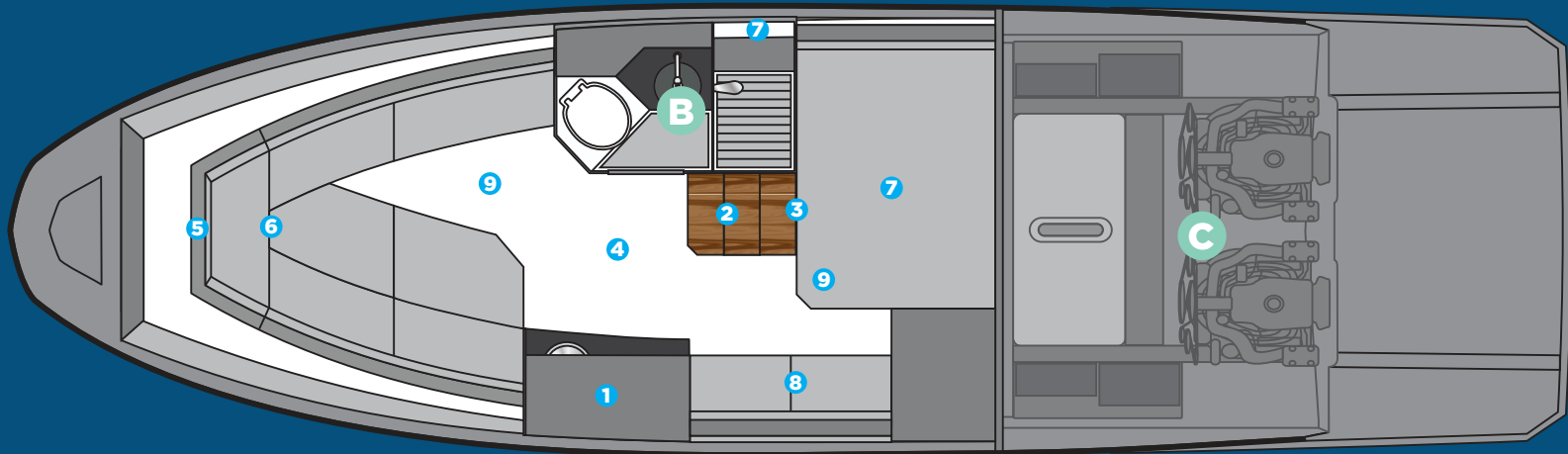

B BATHROOM

- Electric toilet with 22 gallon waste box, macerator pump and external nozzle
- Cabinet with two doors, sink in synthetic granite with bowl overlaid in tempered glass
- Air cabinet with two mirrored doors
- Decorative coating with glass inserts
- Shower box free standing height 6'2" /1,88 min
- Tempered glass box
- Shower with mixer
- Non-slip floor

C ENGINE

- Interior in gray gelcoat
- Non-slip sole, flat
- Insulation, acoustic and thermal
- Fire extinguisher, fixed, with remote activation
- Compartment, sealed, for air conditioning
- Compartment, sealed, for batteries
- Exhaust fans (2)
- Hatch, electric, with push-button
- Access door with gas pistons and lock
- Fuel tank, aluminum, with level gauge

HULL AND COCKPIT

- 1** 1 bow eye
- 2** Stainless steel handrail with teak seat in the bow
- 3** 20" hatch in the bow from cabin to bow area
- 4** 4 panoramic tempered glass windows
- 5** 2 tilting tempered glass windows in the cockpit
- 6** Tempered glass windshield and anodized aluminum frame
- 7** 4-step telescopic ladder on platform
- 8** Triple bow solarium with adjustable backrest
- 9** Handle stainless steel in the gourmet space

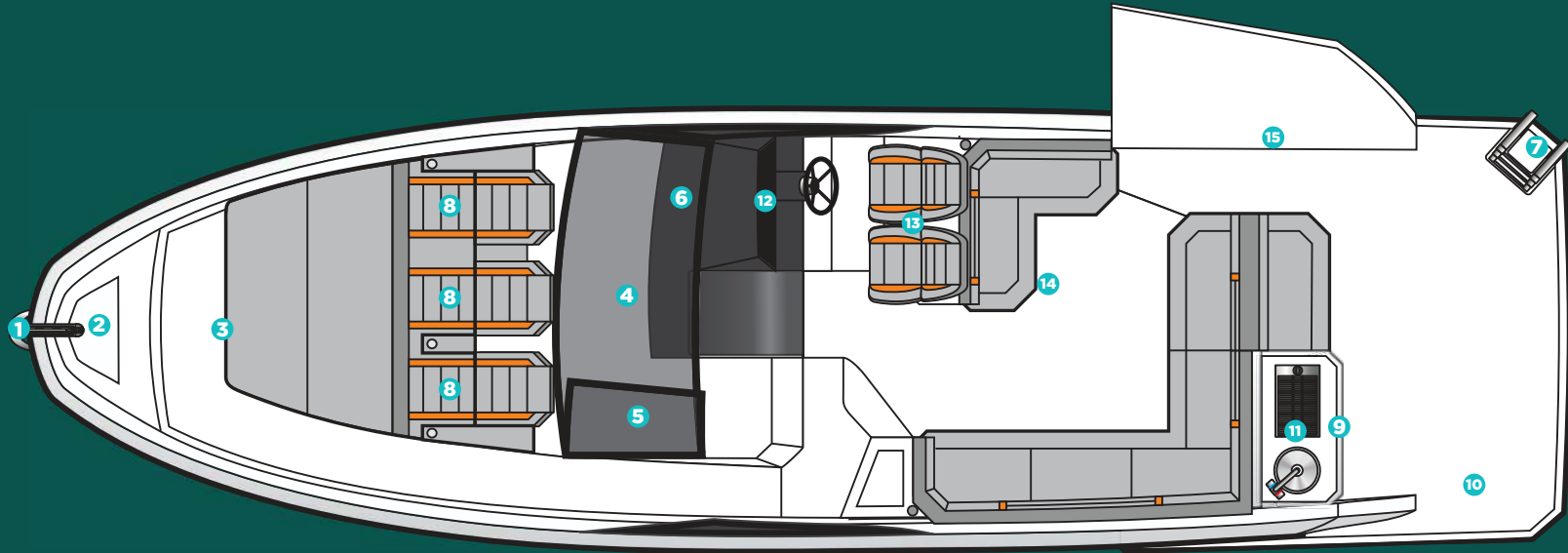

- 10** Teak table
- 11** Gourmet space with top lid, sink, fridge, cutting board
- 12** Instrument panel that supports up to two 9" electronics with built-in compass
- 13** Dual rider seat with standing or sitting
- 14** Two L-shaped sectional sofa in the cockpit and another in the stern
- 15** Opening lateral deck - electrical opening - Beach Club System

An aerial photograph of a small boat moving across the ocean, leaving a large, circular, concentric wake behind it. The water is dark, and the wake is a mix of white foam and greenish-brown water. The text is centered over the wake.

**CUSTOMIZE AND
HAVE THE MOST UNIQUE
VESSEL AT SEA**



FURNITURE VINYL OPTIONS



Salina



Massal

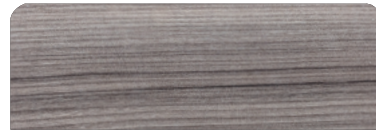

Cherry



Patina



Alder



Bronze

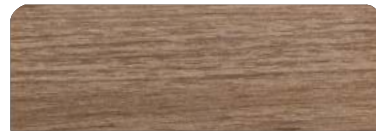

Freije



Taupe Super Matte



Black line



Taupe High Gloss



Canyon



Onix



Metallic



Gray Oak

SYNTHETIC LEATHER OPTIONS



Fern



Terracota



Caramello

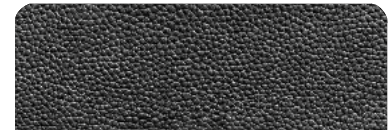

Black



Land Rover



Taupe



Ivory



Orange



Off White



Gray



Silver



Carbon Fiber



White



Beige



Matelasse Honeycomb



New Corolla



Blue



Corolla



EXTERIOR PAINT OPTIONS



Grigio Silver



Moonstone Grey



Pure Grey



Sequin Blue



Orkney Grey (Highgloss Clearcoat)



Orkney Grey (Matte Clearcoat)



Memphis Black (Highgloss Clearcoat)



Heraldic Blue



Memphis Black (Matte Clearcoat)



Naples Gold

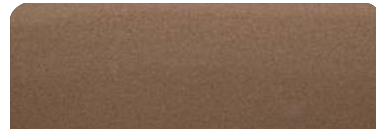

Havanna Brown



Macaw Blue



Orange Pearl



Moscou Red



Marrakesh Brown

INTERIOR PAINT OPTIONS

FLOORING OPTIONS



Ivory Beige



Mist Beige



Terra Brown



White



Corolla Grey



Black



Land Rover



Compass Grey

SYNTHETIC TEAK



Sand



Grey



Madeira

EVA



Tuscany

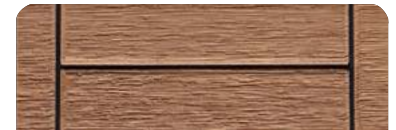

Ocher



Grey

PREMIUM COMFORT

There's plenty of room for sunbathing on the bow and a hangout area at the stern, so bring your friends and family; there's only good times on the HANOVER 387.

With the Hard-Top you have convenience and privacy to feel more comfortable while at sea.

Create and share memories that will last a lifetime.
The choice is yours.

Hanover 387

2023



Hanover 387

2023



Hanover 387

2023

STANDARD EQUIPMENT

HULL AND DECK

- 8" through bolted stainless steel cleats (06 count)
- 1 bow eye
- 2 eyes at the stern
- Stainless steel handrail with teak seat in the bow
- Self-draining floor
- 20" hatch in the bow from cabin to bow area
- 4 panoramic tempered glass windows
- 2 tilting tempered glass windows in the cockpit
- Tempered glass windshield and anodized aluminum frame
- 4-step telescopic ladder on platform
- Double bow solarium with adjustable backrest
- Handle stainless steel in the gourmet space
- Compartment for fenders on the platform floor
- 5 compartments below the cockpit seats
- Teak table
- Upholstery in anti-mold leather
- Gourmet space with top lid, sink, fridge, cutting board
- Hard-Top
- Storage, acrylic
- Acrylic cup holder in the cockpit
- Instrument panel that supports up to two 9" electronics with built-in compass
- Dual rider seat with standing or sitting
- Two seating areas in the cockpit
- Cooler
- Garbage Displacement
- Opening lateral deck - electrical opening - Beach Club System

HEAD

- Electric toilet with 22 gallon waste box, macerator pump and external nozzle
- Cabinet with two doors, sink in synthetic granite with bowl overlaid in tempered glass
- Air cabinet with two mirrored doors
- Decorative coating with glass inserts
- Shower with mixer
- Tempered glass box
- Shower box free standing height 6'2" /1,88 m
- Non-slip floor

CABIN

- Acrylic access sliding door with lock and key
- Stainless steel staircase with 3 wide teak steps
- Ultra moisture resistant MDF furniture
- Kitchen with sink, synthetic granite top, space for microwave, induction stove, fridge, 3 drawers and two cabinets
- Vinilic special flooring
- Decorative mirror on the bow
- U-shaped sofa for 3 people convertibles into a double bed, with teak retractable table
- Couple bed in the middle ship cabin
- Sofa in the middle ship cabin
- Coverings in waterproof fabric or anti-mold nautical leather
- Side walls covered with anti-mold foam and nautical leather
- Luxury layette kit with 10 pillows
- Free standing up of 9' in cabin center

ENGINE ROOM

- Interior in gray gelcoat
- Non-slip sole, flat
- Insulation, acoustic and thermal
- Fire extinguisher, fixed, with remote activation
- Compartment, sealed, for air conditioning and batteries
- Exhaust fans (2)
- Hatch, electric, with push-button
- Access door with gas pistons and lock
- Fuel tank, aluminum, with level gauge

PUMPS AND TANKS

- Water tank, potable, 50 gal
- Fresh water pump
- Bilge pumps, engine room, with automatic switches
- Bilge pump, amidships, with automatic switch
- Collection box for shower with pump
- Showerhead, aft, with mixer

ELECTRICAL

- Circuit breaker board
- Selector switch for pier/generator/inverter
- Electrical panel in the cockpit with special switches
- Navigation lights
- Anchoring lights
- Indirect LED lighting on the cockpit ceiling, bathroom, cabin, cabinet and under the sofas and dashboard
- LED spotlights on the cabin and cockpit ceiling
- Lighting in the engine room
- 120v sockets in the cockpit, cabin and bathroom
- 12v / USB sockets on the dashboard and in the cabin
- Shore power socket
- Individual master switches for accessory batteries and motors

OPTIONS INCLUDED

- Synthetic teak or EVA on bow, cockpit and swim platform
- Sound system
- Anchor Windlass Electric System
- Anchor, 22 lbs, with chain
- VHF Radio w/ Antenna
- Sunroof, electric opening
- Holding tank with macerator
- Air conditioning, 12,000 BTU
- Generator
- Refrigerator,
- Trim tabs, electric
- Spotlights
- Shorepower
- Inverter and charger system + internal AC
- Gourmet Area

ESSENTIAL PACKAGE

**TWIN MERCURY MERCUISER®
300HP DTS BRAVO THREE®**

PREMIUM PACKAGE

**TWIN MERCURY MERCUISER® 350HP BRAVO
THREE® AXIUS W/ JOYSTICK PILOTING**

Engine

GPS

Sound System

Exterior Painting

Power Generator

VHF Radio w/ Antenna

Synthetic Teak or EVA Flooring

Macerator & Holding tank

Anchor Windlass Electric System

A/C (12,000 BTU)

Electric Trim Tabs (Flaps)

Pier Outlet

T-Top with an electric sunroof

RAYMARINE ELEMENT 7S

BOSS SOUND SYSTEM + 6 JBL
Marinized Speakers + Amplifier

1 Color (Hull)

KOHLER® 6KVA



TWIN RAYMARINE AXIOM 9"

**FUSION SOUND SYSTEM +
6 Marinized Speakers + Amplifier**

**2 Colors or More
(Hull, Deck or HT)**

ONAN® 5KVA



Power Inverter



Refrigerator (Cabin)



Windshield Wiper



Electric Boiler System (Toilet)



Complete Design Set (Layette)



Mosaic Cover (Kitchen Wall)



24" LED TV & Blu-Ray Player



Induction Stove (Cabin)



\$395,000

\$429,000

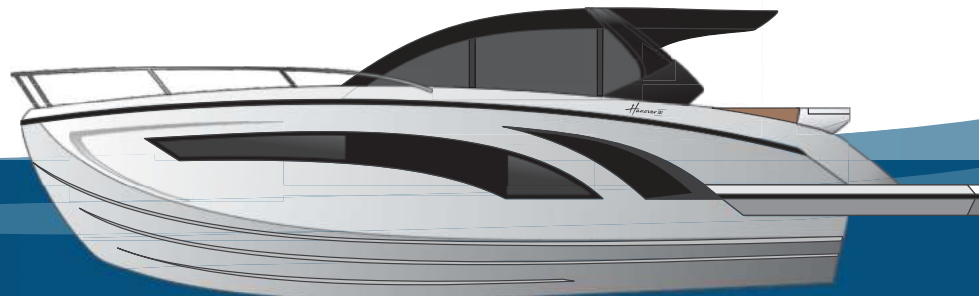

ADDITIONAL UPGRADES



Twin Mercruiser® 380hp Bravo
Three® Axis W/ Joystick Piloting

\$9,775



MC² Quick Gyro X10
Stabilizers

\$46,500



Hydraulic
Swim Platform

\$23,500



Electric Fun
Deck Platform

\$14,500

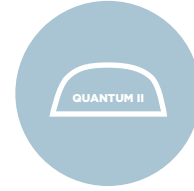

Raymarine Radar
Quantum II

\$6,500

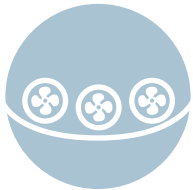

Bow
Thrusters

\$12,500

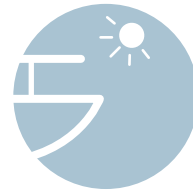

Manual Aft Shade w/
Poles

\$3,200



Electric Aft Shade
(Stobag)

\$4,200



Underwater Lights
(Pair)

\$1,100

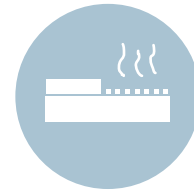

Kenyon Electric BBQ
(Gourmet Area)

\$2,750



Complete Branded
Nylon Cover

\$3,200



Head Lights
w/ Remote

\$1,250



Mid Ship Cabin Room
Enclosure (Wood)

\$3,250

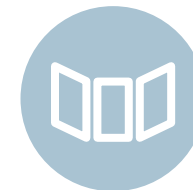

Cockpit Glass Door
Enclosure

\$14,500

HANOVER OWNERSHIP PROGRAM

We want buying and owning a Hanover to be exciting and stress-free so we created an industry-first offering that

sticks to this promise from the moment you're introduced to our brand.

STRESS-FREE PRICING

Our entire lineup is offered at our lowest price, save the haggling for the used car salesman.

FIRST TRIP

Although you'll be prepared with training, you may forget some details during your first cruise due to the distractions of friends, music, and other boats. Let's make your first boat trip as enjoyable as possible.

You will be accompanied by a captain on your first trip (up to 4 hours) to refresh your memory and make you feel like a pro.

MAINTENANCE AND WARRANTY

Similar to a newborn, a boat's first year is extremely important to its happiness and the satisfaction of its owner.

Our experienced team will visit and inspect your boat during the first 30 days of delivery, at 6 months, and once again at 11 months before your 1-year warranty ends. We know preventative maintenance is the key to a healthy vessel.

If it sounds too good to be true, it is, because we are really committed to making you a lifetime boater.

Don't just own a boat, be part of the Hanover Lifestyle

Hanover

Hanover

www.hanoveryachts.com